

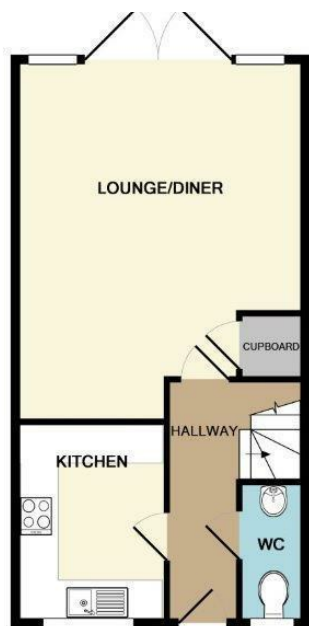

363c Ringwood Road, Poole, BH12 4LT

£325,000

- Three Bedrooms
- Gas Central Heating
- Family Bathroom
- No Forward Chain
- Modern End Of Terrace House
- Downstairs Cloakroom
- Good Size Lounge / Dining Room
- UPVC Double Glazing
- En-Suite To Bedroom One
- Off Road Parking For 2 x Vehicles



GROUND FLOOR
APPROX. FLOOR
AREA 437 SQ.FT.
(40.6 SQ.M.)

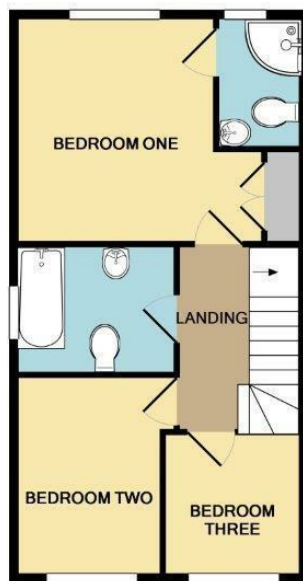

1ST FLOOR
APPROX. FLOOR
AREA 437 SQ.FT.
(40.6 SQ.M.)

TOTAL APPROX. FLOOR AREA 874 SQ.FT. (81.2 SQ.M.)

Whilst every attempt has been made to ensure the accuracy of the floor plan contained here, measurements of doors, windows, rooms and any other items are approximate and no responsibility is taken for any error, omission, or mis-statement. This plan is for illustrative purposes only and should be used as such by any prospective purchaser. The services, systems and appliances shown have not been tested and no guarantee as to their operability or efficiency can be given.
Made with Metropix ©2019

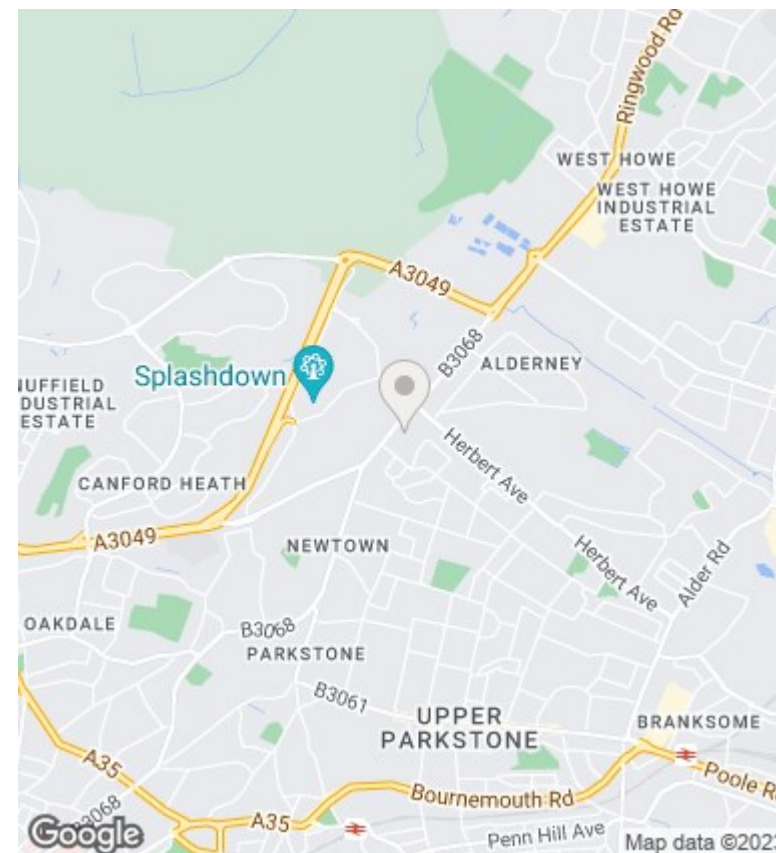

Directions

Viewings

Viewings by arrangement only. Call 01202 749390 to make an appointment.

Council Tax Band

EPC Rating:

Energy Efficiency Rating		
	Current	Potential
<i>Very energy efficient - lower running costs</i>		
(92 plus) A		
(81-91) B		
(69-80) C		
(55-68) D		
(39-54) E		
(21-38) F		
(1-20) G		
<i>Not energy efficient - higher running costs</i>		
England & Wales	EU Directive 2002/91/EC	